

DATE: 11 March 2025
MY REF: Licensing Sub-Committee
YOUR REF:
CONTACT: Democratic Services
TEL NO: 0116 272 7708
EMAIL: committees@blaby.gov.uk

To Members of the Licensing Sub-Committee

Cllr. Nick Chapman
Cllr. Roger Stead (Reserve Member)

Cllr. Janet Forey

Cllr. Susan Findlay

Dear Councillor,

A meeting of the **LICENSING SUB-COMMITTEE** will be held in the Council Chamber - Council Offices, Narborough on **THURSDAY, 20 MARCH 2025** at **4.00 p.m.** for the transaction of the following business and your attendance is requested.

Yours faithfully



Gemma Dennis
Monitoring Officer



AGENDA

1. Election of Chairman

2. Apologies for Absence

3. Disclosures of Interests from Members

To receive disclosures of interests from Members (i.e. the existence and the nature of those interests in respect of items on this agenda).

4. Application to Vary a Premises Licence - Morrisons, Mill Lane, Enderby, Leicestershire LE19 4NL. (Pages 3 - 38)

To consider the report of the Licensing Team Leader (enclosed).

Blaby District Council
Licensing Sub-Committee

Date of Meeting 20 March 2025
Title of Report **Application to vary a premises licence-Morrisons, Mill Lane, Enderby, Leicestershire LE19 4NL**
Report Author Licensing Team Leader

1. What is this report about?

- 1.1 The Licensing Sub-Committee is required to determine an application to vary a premises licence BLPR0026, relating to Morrisons, 29 Mill Lane, Enderby, LE19 4NL.

2. Recommendation

- 2.1 That the Licensing Sub Committee determines an application in accordance with the Licensing Act 2003.
Having considered the application and representations, members must consider whether to
- Grant the licence variation without modification
 - Grant the licence variation subject to conditions
 - Reject the application
- Members must give full reasons for any decision made.

3. Reason for Decision Recommended

- 3.1 The Licensing Act 2003 requires that the Licensing Sub Committee determine a variation of a premises licence where relevant representations are received.

4. Matters to consider

4.1 Background

The Licensing Authority received a complete application for a variation to the premises licence for Morrisons (formerly the Co-Op) on 21st January 2025. The application was submitted in accordance with the requirements of the Licensing Act by the applicant, Samy (County) Limited, and requested the following variations to the activities authorised by the current premises licence:

- To extend the sale of alcohol to 24 hours daily, for consumption off the premises.
- To allow the provision of late night refreshment between the hours of 2300 and 0500 daily.
- To include in Annex 2 the conditions in boxes B to E of Section M of the application.

A copy of the full application is attached at Appendix A.

The steps the applicant proposes to take to promote the licensing objectives are set out in the operating schedule (Section M)

A copy of the existing premises licence is attached as Appendix B.

4.2 Relevant Representations

Responsible Authorities – No representations have been received from any responsible authority.

Other persons- Representations were received from 3 other persons. The representations cover aspects of all four of the licensing objectives. Copies of these representations are attached as Appendix C.

4.3 Appropriate Consultations

The Act requires that the applicant sends a copy of their application to the Licensing Authority and all Responsible Authorities. When the application is accepted the applicant must place a notice detailing the application and the relevant dates for representations to be submitted, once in a local publication and on, at or near to the premises for 28 consecutive days. The Licensing Authority must also display a notice detailing the application on their website for 28 consecutive days commencing on the day after the application has been accepted.

4.4 Significant Issues

There is no requirement for an EINA to be completed for this report.

4.5 In preparing this report, the author has considered issues related to Human Rights, Legal Matters, Human Resources, Equalities, Public Health Inequalities and there are no areas of concern.

5. Environmental impact

5.1 No Net Zero and Climate Impact Assessment (NZCIA) is required for this report.

6. Appendix

- 6.1 Appendix A – Application to vary the premises licence
- 6.2 Appendix B – Existing Premises Licence
- 6.3 Appendix C – Representations made by other persons

7. Background paper(s)

- 7.1 The Licensing Sub-Committee shall refer to the current Statement of Licensing Policy, in particular sections;
- 3.0 Licensable Activities
 - 5.0 Licensing Hours
 - 6.0 Promotion of the Licensing Objectives
 - 7.0 Prevention of Public Nuisance
 - 8.0 Prevention of Crime and Disorder
 - 9.0 Public Safety
 - 10.0 The Protection of Children from Harm
 - 19.0 Standardised Conditions.

The current Guidance, issued by the Home Office under Section 182 of the Licensing Act 2003 (updated February 2025) should also be taken into consideration. In particular.

Section 1.2 – 1.5 Licensing objectives and aims

1.15 – 1.17 General Principles

2.0 - 2.38 The Licensing Objectives

9.31 – 9.41 Hearings

9.42 – 9.44 Determining actions that are appropriate for the promotion of the Licensing objectives

10.1 – 10.3 Conditions - general

10.8 – 10.9 Imposed conditions

8. Report author's contact details

Jamie Osborne Licensing Team Leader

Jamie.osborne@blaby.gov.uk 0116 274 7513

This page is intentionally left blank

Application to vary a premises licence under the Licensing Act 2003

PLEASE READ THE FOLLOWING INSTRUCTIONS FIRST

Before completing this form please read the guidance notes at the end of the form. If you are completing this form by hand please write legibly in block capitals. In all cases ensure that your answers are inside the boxes and written in black ink. Use additional sheets if necessary.

You may wish to keep a copy of the completed form for your records.

I/We Samy (County) Limited

(Insert name(s) of applicant)

being the premises licence holder, apply to vary a premises licence under section 34 of the Licensing Act 2003 for the premises described in Part 1 below

Premises licence number BLPR0009
--

Part 1 – Premises Details

Postal address of premises or, if none, ordnance survey map reference or description Mill Lane			
Post town	Enderby	Postcode	LE19 4NL

Telephone number at premises (if any)	
Non-domestic rateable value of premises	£45,750

Part 2 – Applicant details

Daytime contact telephone number			
E-mail address (optional)			
Current postal address if different from premises address	73-75 Corporation Road		
Post town	Middlesbrough	Postcode	TS1 1LY

Part 3 - Variation

Please tick as appropriate

Do you want the proposed variation to have effect as soon as possible?

☒ Yes

☐
No

If not, from what date do you want the variation to take effect?

DD		MM		YYYY			
<input type="text"/>	<input type="text"/>	<input type="text"/>	<input type="text"/>	<input type="text"/>	<input type="text"/>	<input type="text"/>	<input type="text"/>

Do you want the proposed variation to have effect in relation to the introduction of the late night levy? (Please see guidance note 1) ☐ Yes ☒ No

Please describe briefly the nature of the proposed variation (Please see guidance note 2)

The premises is a convenience store located on Mill Lane, Enderby, LE19 4NL

The variation is to do the following:

1. Extension of the hours for the sale of alcohol to 24 hours daily.
2. Provision of late night refreshment between the hours of 2300 and 0500 daily.
3. To include in Annex 2 the conditions in boxes b to e of Section M of the application.

If your proposed variation would mean that 5,000 or more people are expected to attend the premises at any one time, please state the number expected to attend:

Part 4 Operating Schedule

Please complete those parts of the Operating Schedule below which would be subject to change if this application to vary is successful.

Provision of regulated entertainment (Please see guidance note 3) Please tick all that apply

- a) plays (if ticking yes, fill in box A) ☐
- b) films (if ticking yes, fill in box B) ☐
- c) indoor sporting events (if ticking yes, fill in box C) ☐
- d) boxing or wrestling entertainment (if ticking yes, fill in box D) ☐
- e) live music (if ticking yes, fill in box E) ☐
- f) recorded music (if ticking yes, fill in box F) ☐
- g) performances of dance (if ticking yes, fill in box G) ☐
- h) anything of a similar description to that falling within (e), (f) or (g) (if ticking yes, fill in box H) ☐

Provision of late night refreshment (if ticking yes, fill in box I) ☒

Supply of alcohol (if ticking yes, fill in box J) ☒

In all cases complete boxes K, L and M

A

Plays Standard days and timings (please read guidance note 8)			<u>Will the performance of a play take place indoors or outdoors or both – please tick</u> (please read guidance note 4)	Indoors	<input type="checkbox"/>
				Outdoors	<input type="checkbox"/>
Day	Start	Finish		Both	<input type="checkbox"/>
Mon			<u>Please give further details here</u> (please read guidance note 5)		
Tue					
Wed			<u>State any seasonal variations for performing plays</u> (please read guidance note 6)		
Thur					
Fri			<u>Non standard timings. Where you intend to use the premises for the performance of plays at different times to those listed in the column on the left, please list</u> (please read guidance note 7)		
Sat					
Sun					

B

Films Standard days and timings (please read guidance note 8)			<u>Will the exhibition of films take place indoors or outdoors or both – please tick</u> (please read guidance note 4)	Indoors	<input type="checkbox"/>
				Outdoors	<input type="checkbox"/>
				Both	<input type="checkbox"/>
Day	Start	Finish			
Mon			<u>Please give further details here</u> (please read guidance note 5)		
Tue					
Wed			<u>State any seasonal variations for the exhibition of films</u> (please read guidance note 6)		
Thur					
Fri			<u>Non standard timings. Where you intend to use the premises for the exhibition of films at different times to those listed in the column on the left, please list</u> (please read guidance note 7)		
Sat					
Sun					

C

Indoor sporting events Standard days and timings (please read guidance note 8)			Please give further details (please read guidance note 5)
Day	Start	Finish	
Mon			
Tue			State any seasonal variations for indoor sporting events (please read guidance note 6)
Wed			
Thur			
Fri			Non standard timings. Where you intend to use the premises for indoor sporting events at different times to those listed in the column on the left, please list (please read guidance note 7)
Sat			
Sun			

D

Boxing or wrestling entertainments Standard days and timings (please read guidance note 8)			<u>Will the boxing or wrestling entertainment take place indoors or outdoors or both – please tick</u> (please read guidance note 4)	Indoors	<input type="checkbox"/>
				Outdoors	<input type="checkbox"/>
				Both	<input type="checkbox"/>
Day	Start	Finish			
Mon			<u>Please give further details here</u> (please read guidance note 5)		
Tue					
Wed			<u>State any seasonal variations for boxing or wrestling entertainment</u> (please read guidance note 6)		
Thur					
Fri			<u>Non standard timings. Where you intend to use the premises for boxing or wrestling entertainment at different times to those listed in the column on the left, please list</u> (please read guidance note 7)		
Sat					
Sun					

E

Live music Standard days and timings (please read guidance note 8)			<u>Will the performance of live music take place indoors or outdoors or both – please tick</u> (please read guidance note 4)	Indoors	<input type="checkbox"/>
				Outdoors	<input type="checkbox"/>
Day	Start	Finish		Both	<input type="checkbox"/>
Mon			<u>Please give further details here</u> (please read guidance note 5)		
Tue					
Wed			<u>State any seasonal variations for the performance of live music</u> (please read guidance note 6)		
Thur					
Fri			<u>Non standard timings. Where you intend to use the premises for the performance of live music at different times to those listed in the column on the left, please list</u> (please read guidance note 7)		
Sat					
Sun					

F

Recorded music Standard days and timings (please read guidance note 8)			<u>Will the playing of recorded music take place indoors or outdoors or both – please tick</u> (please read guidance note 4)	Indoors	<input type="checkbox"/>
				Outdoors	<input type="checkbox"/>
Day	Start	Finish		Both	<input type="checkbox"/>
Mon			<u>Please give further details here</u> (please read guidance note 5)		
Tue					
Wed			<u>State any seasonal variations for the playing of recorded music</u> (please read guidance note 6)		
Thur					
Fri			<u>Non standard timings. Where you intend to use the premises for the playing of recorded music at different times to those listed in the column on the left, please list</u> (please read guidance note 7)		
Sat					
Sun					

G

Performances of dance Standard days and timings (please read guidance note 8)			<u>Will the performance of dance take place indoors or outdoors or both – please tick</u> (please read guidance note 4)	Indoors	<input type="checkbox"/>
				Outdoors	<input type="checkbox"/>
				Both	<input type="checkbox"/>
Day	Start	Finish			
Mon			<u>Please give further details here</u> (please read guidance note 5)		
Tue					
Wed			<u>State any seasonal variations for the performance of dance</u> (please read guidance note 6)		
Thur					
Fri			<u>Non standard timings. Where you intend to use the premises for the performance of dance at different times to those listed in the column on the left, please list</u> (please read guidance note 7)		
Sat					
Sun					

H

Anything of a similar description to that falling within (e), (f) or (g) Standard days and timings (please read guidance note 8)			Please give a description of the type of entertainment you will be providing		
Day	Start	Finish	<u>Will this entertainment take place indoors or outdoors or both – please tick</u> (please read guidance note 4)	Indoors	<input type="checkbox"/>
Mon				Outdoors	<input type="checkbox"/>
				Both	<input type="checkbox"/>
Tue			<u>Please give further details here</u> (please read guidance note 5)		
Wed			<u>Please give further details here</u> (please read guidance note 5)		
Thur			<u>State any seasonal variations for entertainment of a similar description to that falling within (e), (f) or (g)</u> (please read guidance note 6)		
Fri			<u>State any seasonal variations for entertainment of a similar description to that falling within (e), (f) or (g)</u> (please read guidance note 6)		
Sat			<u>Non standard timings. Where you intend to use the premises for the entertainment of a similar description to that falling within (e), (f) or (g) at different times to those listed in the column on the left, please list</u> (please read guidance note 7)		
Sun			<u>Non standard timings. Where you intend to use the premises for the entertainment of a similar description to that falling within (e), (f) or (g) at different times to those listed in the column on the left, please list</u> (please read guidance note 7)		

I

Late night refreshment Standard days and timings (please read guidance note 8)			<u>Will the provision of late night refreshment take place indoors or outdoors or both – please tick</u> (please read guidance note 4)	Indoors	<input type="checkbox"/>
				Outdoors	<input type="checkbox"/>
				Both	<input checked="" type="checkbox"/>
Day	Start	Finish			
Mon	23:00	05:00	<u>Please give further details here</u> (please read guidance note 5) The provision will take place inside the premises but customers may leave the premises with items purchased.		
Tue	23:00	05:00			
Wed	23:00	05:00	<u>State any seasonal variations for the provision of late night refreshment</u> (please read guidance note 6)		
Thur	23:00	05:00			
Fri	23:00	05:00	<u>Non standard timings. Where you intend to use the premises for the provision of late night refreshment at different times, to those listed in the column on the left, please list</u> (please read guidance note 7)		
Sat	23:00	05:00			
Sun	23:00	05:00			

J

Supply of alcohol Standard days and timings (please read guidance note 8)			Will the supply of alcohol be for consumption – please tick (please read guidance note 9)	On the premises	<input type="checkbox"/>	
				Off the premises	<input checked="" type="checkbox"/>	
				Both	<input type="checkbox"/>	
Day	Start	Finish	<u>State any seasonal variations for the supply of alcohol</u> (please read guidance note 6)			
Mon	00:00	24:00				
Tue	00:00	24:00				
Wed	00:00	24:00				
Thur	00:00	24:00				<u>Non-standard timings. Where you intend to use the premises for the supply of alcohol at different times to those listed in the column on the left, please list</u> (please read guidance note 7)
Fri	00:00	24:00				
Sat	00:00	24:00				
Sun	00:00	24:00				

K

<p>Please highlight any adult entertainment or services, activities, other entertainment or matters ancillary to the use of the premises that may give rise to concern in respect of children (please read guidance note 10).</p> <p>NA</p>
--

L

Hours premises are open to the public Standard days and timings (please read guidance note 8)			<u>State any seasonal variations</u> (please read guidance note 6)
Day	Start	Finish	
Mon	00:00	24:00	
Tue	00:00	24:00	<u>Non standard timings. Where you intend the premises to be open to the public at different times from those listed in the column on the left, please list</u> (please read guidance note 7)
Wed	00:00	24:00	
Thur	00:00	24:00	
Fri	00:00	24:00	
Sat	00:00	24:00	
Sun	00:00	24:00	

Please identify those conditions currently imposed on the licence which you believe could be removed as a consequence of the proposed variation you are seeking.

There are currently no conditions attached to the licence.

Please tick as appropriate

- I have enclosed the premises licence ☒
- I have enclosed the relevant part of the premises licence ☐

If you have not ticked one of these boxes, please fill in reasons for not including the licence or part of it below

Reasons why I have not enclosed the premises licence or relevant part of premises licence.

M Describe any additional steps you intend to take to promote the four licensing objectives as a result of the proposed variation:

a) General – all four licensing objectives (b, c, d and e) (please read guidance note 11)

b) The prevention of crime and disorder

1. A digital CCTV system will be installed, or the existing system maintained, such system to be fit for the purpose.
 2. The CCTV system shall be capable of producing immediate copies on site. Copies of recordings will either be recorded digitally on to CD/DVD or other equivalent medium.
 3. Any recording will be retained and stored in a suitable and secure manner for a minimum of 31 days and shall be made available, subject to compliance with Data Protection legislation, to the police for inspection on request.
 4. The precise positions of the camera may be agreed, subject to compliance with Data Protection legislation, with the police from time to time.
 5. The system will display, on any recording, the correct time and date of the recording.
 6. The CCTV system will be maintained and fully operational throughout the hours that the premises are open for any licensable activity.
 7. An incident book/register shall be maintained to record:
 - all incidents of crime and disorder occurring at the premises
 - details of occasions when the police are called to the premises
- This book/register shall be available for inspection by a police officer or other authorised officer on request.

c) Public safety

There will at all times be adequate levels of staff maintained at the premises. Such staff levels will be disclosed, on request, to the licensing authority and police.

d) The prevention of public nuisance

Adequate waste receptacles for use by customers shall be provided in and immediately outside the premises.

e) The protection of children from harm

1. The premises licence holder will ensure that an age verification policy will apply to the premises whereby all cashiers will be trained to ask any customer attempting to purchase alcohol, who appears to be under the age of 25 years (or older if the licence holder so elects) to produce, before being sold alcohol, identification being a passport or photocard driving licence bearing a holographic mark or other form of identification that complies with any mandatory condition that may apply to this licence.

2. Signage informing customers of the age verification policy adopted at the premises will be prominently displayed.

3. All staff engaged or to be engaged in the sale of alcohol on the premises shall receive training in age restricted sales.

Induction training must be completed and documented prior to the sale of alcohol by the staff member.

Refresher/reinforcement training must be completed and documented at intervals of no more than 6 months.

Training records will be available for inspection by a police officer or other authorised officer on request.

4. All cashiers shall be trained to record refusals of sales of alcohol in a refusals book/register. The book/register will contain:

- details of the time and date the refusal was made;
- the identity of the staff member refusing the sale;
- details of the alcohol the person attempted to purchase.

This book/register shall be available for inspection by a police officer or other authorised officer on request.

Checklist:

Please tick to indicate agreement

- I have made or enclosed payment of the fee; or ☒
- I have not made or enclosed payment of the fee because this application has been made in relation to the introduction of the late night levy. ☐
- I have sent copies of this application and the plan to responsible authorities and others where applicable. ☒

- I understand that I must now advertise my application. ☒
- I have enclosed the premises licence or relevant part of it or explanation. ☒
- I understand that if I do not comply with the above requirements my application will be rejected. ☒

IT IS AN OFFENCE, UNDER SECTION 158 OF THE LICENSING ACT 2003, TO MAKE A FALSE STATEMENT IN OR IN CONNECTION WITH THIS APPLICATION. THOSE WHO MAKE A FALSE STATEMENT MAY BE LIABLE ON SUMMARY CONVICTION TO A FINE OF ANY AMOUNT.

Part 5 – Signatures (please read guidance note 12)

Signature of applicant (the current premises licence holder) or applicant's solicitor or other duly authorised agent (please read guidance note 13). **If signing on behalf of the applicant, please state in what capacity.**

Signature	<i>Winckworth Sherwood LLP</i>
Date	28 th January 2025
Capacity	Agent

Where the premises licence is jointly held, signature of 2nd applicant (the current premises licence holder) or 2nd applicant's solicitor or other authorised agent (please read guidance note 14). **If signing on behalf of the applicant, please state in what capacity.**

Signature	
Date	
Capacity	

Contact name (where not previously given) and address for correspondence associated with this application (please read guidance note 15)

AGS/44519/9

Winckworth Sherwood LLP

Arbor

255 Blackfriars Road

Post town	London	Post code	SE1 9AX
Telephone number (if any)	0207 593 0250		

If you would prefer us to correspond with you by e-mail, your e-mail address (optional)
asanders@wslaw.co.uk

LICENSING ACT 2003

BLPR0009

PREMISES LICENCE

Licensing Authority



Part 1 – Premises Details

Central England Co-operative Limited

Mill Lane
Enderby
Leicestershire
LE19 4NL

Telephone Number:

Where the Licence is time limited the dates:

Not applicable

Licensable Activities authorised by the licence:

Sale by retail of alcohol;

The times the licence authorises the carrying out of licensable activities:

Sale by retail of alcohol

When
Everyday

Times
07:00 - 22:00

The opening hours of the premises:

Everyday

07:00

22:00

Where the licence authorises supplies of alcohol whether these are on and /or off supplies:

Alcohol is supplied for consumption off the Premises

Part 2

Name, (registered) address, telephone number and email (where relevant) of holder of premises licence:

Central England Co-operative Limited
Central House, Queen Street, Lichfield , Staffordshire, WS13 6QD

Registered number of holder, for example company number, charity number (where applicable)	
Name address and telephone number of designated premises supervisor where the premises licence authorises the supply of alcohol:	
Mr Matthew Harper 84 Packer Avenue Leicester Forest East Leicester Leicestershire LE3 3QG	
Personal Licence number and issuing authority of Personal Licence held by Designated Premises Supervisor (where the premises authorises for the supply of alcohol):	
Personal licence Number: Licensing Authority:	Licence Number: BLP1005 Licensing Authority: Blaby District Council

ANNEXES
ANNEX 1 – MANDATORY CONDITIONS
ANNEX 2 – CONDITIONS CONSISTENT WITH THE OPERATING SCHEDULE
ANNEX 3 – CONDITIONS ATTACHED AFTER A HEARING
ANNEX 4 – AUTHORISED PLANS
As attached.
 Caroline Harbour Environmental Health, Housing & Community Services Group Manager



Part 1 – Premises Details

Central England Co-operative Limited

Mill Lane
Enderby
Leicestershire
LE19 4NL

Telephone Number:

Where the Licence is time limited the dates:

Not applicable

Licensable Activities authorised by the licence:

Sale by retail of alcohol;

The times the licence authorises the carrying out of licensable activities:

Sale by retail of alcohol

When
Everyday

Times
07:00 - 22:00

The opening hours of the premises:

Everyday

07:00

22:00

Where the licence authorises supplies of alcohol whether these are on and /or off supplies:

Alcohol is supplied for consumption off the Premises

Part 2

Name, (registered) address, telephone number and email (where relevant) of holder of premises licence:

Central England Co-operative Limited
Central House, Queen Street, Lichfield , Staffordshire, WS13 6QD

Registered number of holder, for example company number, charity number (where applicable)

Name of designated premises supervisor where the premises licence authorises the supply of alcohol:

Mr Matthew Harper

State whether access to the premises by children is restricted or prohibited:



Caroline Harbour
Environmental Health, Housing & Community Services Group Manager

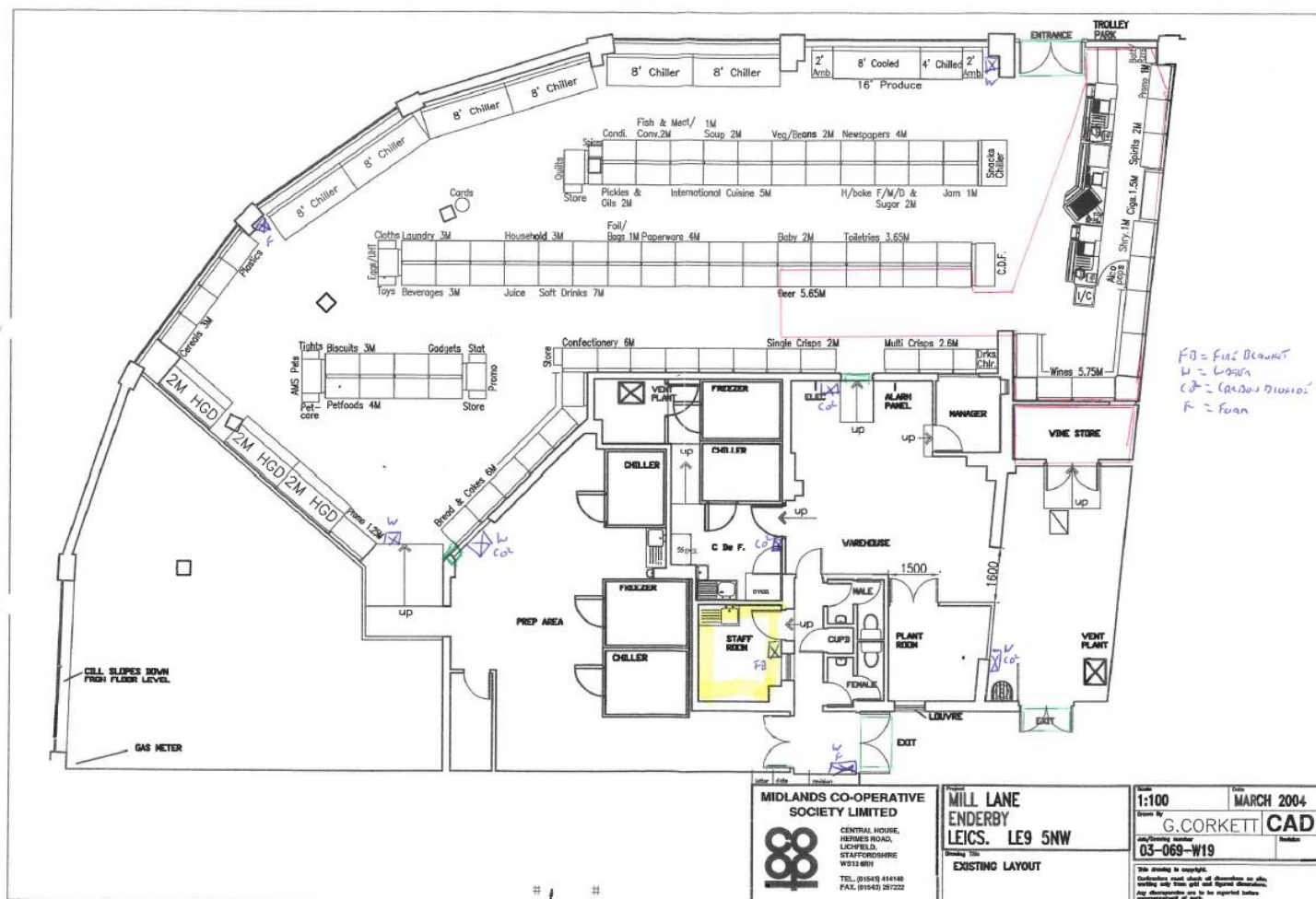

**BLABY DISTRICT COUNCIL
LICENSING ACT 2003**

REPRESENTATION FORM

Your name/organisation name/name of body you represent	Cllr Hannah Gill Councillor for BDC
Address of person/organisation making representation	BDC
Name of the premises you are making a representation about	Morrisons Daily, Enderby
Address of the premises you are making a representation about	Morrisons Daily, Mill Lane, Enderby

What are you making a representation about?
Please indicate which part of the licence/certificate application you are making a representation about (E.g. terminal hours, music and dancing, operating schedule)
I wish to object to the licencing for a 24 hours license of the Morisons Daily in Enderby.

Your representation must relate to one of the four Licensing Objectives

Licensing Objective	<i>Please provide full details of your concerns regarding the application and include any evidence you may have in support of it. Please use separate sheets if necessary</i>
To prevent crime and disorder	<ul style="list-style-type: none"> Studies, including those cited by the Institute of Alcohol Studies, demonstrate a clear link between extended alcohol availability and increased crime rates, particularly anti-social behaviour, public drunkenness, and property damage. We do not need this within Enderby considering that there are 3 pubs and a club within a short distance, one being across the road. The Home Office's guidance under Section 182 of the Licensing Act 2003 highlights that license holders must demonstrate they can mitigate risks of crime and disorder, particularly during late-night hours. I do not feel that this can be offered by the company. It has been demonstrated with the sale of medication that they cannot adhere to guidance when selling items. I will also draw your attention to issues with the storage of food waste where over 20 binbags were stacked up against residents fences rather than in secure food wate bins. Again if they cannot adhere to simple procedural policies then how can they guarantee to reduce the risk of crime and disorder locally. Extending sales to 24/7 in the area increases the likelihood of crime and disorder, especially when alcohol is accessible during peak hours of vulnerability (e.g., late nights and early mornings).
Public safety	<ul style="list-style-type: none"> Public safety concerns are supported by statistics from Public Health England, which report increased alcohol-related

	<p>incidents, including road traffic accidents, when alcohol is available late at night. The police and emergency services in Blaby District are already under pressure, and additional alcohol availability may exacerbate strain, especially given the location's proximity to high-traffic roads and residential areas. There was a recent stabbing outside of the store prior to the change in ownership which is just one example of multiple antisocial issues that have occurred in recent years which include shootings and stabbings.</p> <ul style="list-style-type: none"> Under Section 182 of the Licensing Act, licensing authorities must consider the cumulative impact of multiple alcohol-selling venues in a concentrated area. The existing availability of alcohol through nearby pubs and the 24-hour Asda suggests that an additional 24/7 license may increase risks for drink driving and other alcohol-induced hazards.
To prevent public nuisance	<ul style="list-style-type: none"> Noise, littering, and disturbances are common complaints associated with late-night alcohol sales. The Environmental Protection Act 1990 emphasizes the duty of care to prevent noise pollution and other disturbances, especially in residential areas. Enderby is predominantly residential, and extended alcohol sales could result in late-night disturbances from intoxicated individuals, particularly with people loitering around the store or consuming alcohol nearby. This is a documented issue in communities with 24/7 alcohol availability. As per Section 182 of the Licensing Act, the licensing authority must consider whether granting a license will undermine the ability to prevent public nuisances, particularly in areas with known vulnerabilities, such as residential zones. This store sits within close proximity to residential dwellings as mentioned above the managements inability to follow correct procedures in other areas really undermines their ability to protect residents from increased levels of public nuisance.
To protect children from harm	<p>Proximity to schools and nurseries raises concerns about children being exposed to the consequences of increased alcohol availability. Studies show that areas with unrestricted alcohol availability often report higher instances of underage drinking and exposure to inappropriate behaviour. Children walking near the premises or passing through the area would face greater risks of witnessing anti-social behaviour or encountering intoxicated individuals, undermining their safety. Within a few hundred yards there is a Primary School, Secondary school and two Nursery schools. Enderby is home to families with young children and teenagers and extended licensing hours could lead to higher levels of underage drinking.</p>
Please suggest any conditions that could be added to the licence to remedy your representation or other suggestions you would like the Licensing Sub Committee to take into account.	<ul style="list-style-type: none"> Licensing Act 2003: Section 182 guidance emphasizes that licensing authorities have the power to reject applications when they undermine any of the four licensing objectives. The cumulative impact of multiple licensed premises in close proximity must be taken into account. Cumulative Impact Policy (CIP): Although Enderby may not formally have a CIP, licensing authorities can consider

	<p>cumulative impacts informally when assessing the risks of granting a license. This should be done with this licence.</p> <ul style="list-style-type: none"> • Case Study (precedent): Decisions in other local authorities have demonstrated the rejection of 24/7 licenses where proximity to schools and residential areas posed risks of harm, even when no formal CIP was in place. <p>Considering all of this, plus previous decisions in other localities I strongly object to this licence.</p>
--	---

Signed: Cllr Hannah Gill

Date: 25.02.2025

Capacity: Councillor for BDC

NOT FOR PUBLICATION

Your e-mail address	
Your contact telephone number	

SUPPORTING NOTES

If you do make a representation, it can only relate to the four Licensing Objectives. If relevant and accepted, you will be invited to attend a meeting of the Licensing Sub Committee and any subsequent appeal proceeding. If you do not attend, the Sub Committee will still consider any representations that you have made.

Your representation will also be passed to the applicant, to allow them the opportunity of addressing your concerns. Your representations will be published in the report available to the Sub Committee, which will be publicly available. Names and addresses will only be withheld from the applicant or Sub Committee in exceptional circumstances (email addresses and contact telephone numbers will not be publicly available). If you do not wish for your personal details to be disclosed, then you must withdraw your representation.

This form must be returned within the Statutory Period, which is 28 days from the date the notice was displayed on the premises or the date specified in the Public Notice in the newspaper. Please contact the Licensing Section on 0116 272 7782 if you are in doubt about the date.

Please return this form when completed along with any additional sheets to:

Licensing
Blaby District Council
Council Offices
Desford Road
Narborough
Leicester
LE19 2EP

Or

By email: licensing@blaby.gov.uk

Tel: 0116 272 7782

**BLABY DISTRICT COUNCIL
LICENSING ACT 2003**

REPRESENTATION FORM

Your name/organisation name/name of body you represent	Mark & Anita Brown
Address of person/organisation making representation	4, George Street, Enderby, Leicestershire, LE19 4NQ
Name of the premises you are making a representation about	Morrisons Daily, Enderby
Address of the premises you are making a representation about	Morrisons Daily, Mill Lane, Enderby

What are you making a representation about?
Please indicate which part of the licence/certificate application you are making a representation about (E.g. terminal hours, music and dancing, operating schedule)
The licencing of this site for twenty-four-hour sale of alcohol in a semi residential area of the viilage

Your representation must relate to one of the four Licensing Objectives

Licensing Objective	<i>Please provide full details of your concerns regarding the application and include any evidence you may have in support of it. Please use separate sheets if necessary</i>
To prevent crime and disorder	Please see "Prevent public nuisance"
Public safety	Please see "Prevent public nuisance"
To prevent public nuisance	We are concerned that the availability of alcohol throughout the night in that location will result in additional noise, increased movement of traffic and the congregation of people (with the increased risk for anti-social behaviour) in a semi-residential area. of a village. We must emphasise our fear that the limited availability of late-night alcohol in the surrounding area would bring a risk of a stream of customers arriving in the village, encouraging late night drinking, with the possibility that many people will remain in the vicinity for extended periods of time.
To protect children from harm	

Please suggest any conditions that could be added to the licence to remedy your representation or other suggestions you would like the Licensing Sub Committee to take into account.	<p>It is difficult to think of any remedies except the application of certain limits to the times allowed in the licence.</p> <p style="text-align: center;">Page 33</p>
---	---

Signed: Mark & Anita Brown

Date: 25/02/2025

Capacity: Local Residents

NOT FOR PUBLICATION

Your e-mail address	
Your contact telephone number	

SUPPORTING NOTES

If you do make a representation, it can only relate to the four Licensing Objectives. If relevant and accepted, you will be invited to attend a meeting of the Licensing Sub Committee and any subsequent appeal proceeding. If you do not attend, the Sub Committee will still consider any representations that you have made.

Your representation will also be passed to the applicant, to allow them the opportunity of addressing your concerns. Your representations will be published in the report available to the Sub Committee, which will be publicly available. Names and addresses will only be withheld from the applicant or Sub Committee in exceptional circumstances (email addresses and contact telephone numbers will not be publicly available). If you do not wish for your personal details to be disclosed, then you must withdraw your representation.

This form must be returned within the Statutory Period, which is 28 days from the date the notice was displayed on the premises or the date specified in the Public Notice in the newspaper. Please contact the Licensing Section on 0116 272 7782 if you are in doubt about the date.

Please return this form when completed along with any additional sheets to:

Licensing
Blaby District Council
Council Offices
Desford Road
Narborough
Leicester
LE19 2EP

Or

By email: licensing@blaby.gov.uk

Tel: 0116 272 7782

This page is intentionally left blank

**BLABY DISTRICT COUNCIL
LICENSING ACT 2003**

REPRESENTATION FORM

Your name/organisation name/name of body you represent	Mr S & Mrs C Golby
Address of person/organisation making representation	12 Co-operation, Street Enderby, Leicester, England, LE19 4NG, U
Name of the premises you are making a representation about	Morrisons daily Enderby
Address of the premises you are making a representation about	MillLane Enderby

What are you making a representation about?
Please indicate which part of the licence/certificate application you are making a representation about (E.g. terminal hours, music and dancing, operating schedule)
The sale of alcohol 24 hours a day

Your representation must relate to one of the four Licensing Objectives

Licensing Objective	<i>Please provide full details of your concerns regarding the application and include any evidence you may have in support of it. Please use separate sheets if necessary</i>
To prevent crime and disorder	Because if people are buying alcohol & drinking it in the area during the night it could lead to problems to residents involving the theft or damage to cars or property.
Public safety	We feel the sale of alcohol at all hours could increase the risk of causing anti social behaviour which puts the public at risk
To prevent public nuisance	
To protect children from harm	

Please suggest any conditions that could be added to the licence to remedy your representation or other suggestions you would like the Licensing Sub Committee to take into account.	We don't feel there's a need for the sale of alcohol 24 hours a day In this village especially in a residential area.
---	---

Signed:



Date:

19/02/25

Capacity:

Local residents

NOT FOR PUBLICATION

Your e-mail address	
Your contact telephone number	

SUPPORTING NOTES

If you do make a representation, it can only relate to the four Licensing Objectives. If relevant and accepted, you will be invited to attend a meeting of the Licensing Sub Committee and any subsequent appeal proceeding. If you do not attend, the Sub Committee will still consider any representations that you have made.

Your representation will also be passed to the applicant, to allow them the opportunity of addressing your concerns. Your representations will be published in the report available to the Sub Committee, which will be publicly available. Names and addresses will only be withheld from the applicant or Sub Committee in exceptional circumstances (email addresses and contact telephone numbers will not be publicly available). If you do not wish for your personal details to be disclosed, then you must withdraw your representation.

This form must be returned within the Statutory Period, which is 28 days from the date the notice was displayed on the premises or the date specified in the Public Notice in the newspaper. Please contact the Licensing Section on 0116 272 7782 if you are in doubt about the date.

Please return this form when completed along with any additional sheets to:

Licensing
Blaby District Council
Council Offices
Desford Road
Narborough
Leicester
LE19 2EP

Or

By email: licensing@blaby.gov.uk

Tel: 0116 272 7782